

PAPADIMITROPOULOS PANAGIOTIS
 IMPORTS - DEALING CUTTING TOOLS
 FOR WOOD, METAL, ALUMINIUM
 44 DAVAKI, AG. DIMITRIOS, 17343 ATHE
 TEL&FAX: +30-210-9750575
 MOB: +30-6932-469121
 Email: info@papadimitropoulos.gr
 www.papadimitropoulos.gr



ΠΑΠΑΔΗΜΗΤΡΟΠΟΥΛΟΣ ΠΑΝΑΓΙΩΤΗΣ
 ΕΙΣΑΓΩΓΕΣ-ΕΜΠΟΡΙΟ ΚΟΠΤΙΚΩΝ ΕΡΓΑΛΕΙΩΝ
 ΞΥΛΟΥ, ΣΙΔΗΡΟΥ, ΑΛΟΥΜΙΝΙΟΥ
 ΔΑΒΑΚΗ 44, ΑΓ. ΔΗΜΗΤΡΙΟΣ, 17343, ΑΘΗΝΑ
 ΤΗΛ & FAX : 210-9750575
 ΚΙΝ : 6932-469121
 Email: info@papadimitropoulos.gr
 www.papadimitropoulos.gr

ΤΣΤ ΕΝΑΛΛΑΣ/ΝΑ ΠΛΑΚΙΔΙΑ (SQUARE KNIVES) ΤΙΜΟΚΑΤΑΛΟΓΟΣ

2013

REVERSIBLE HM INTEGRAL KNIVES

9503...

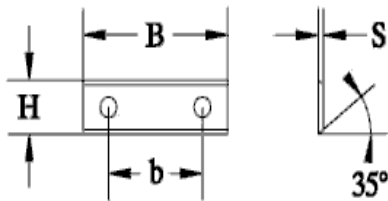

B	H	S	b	β		€
7,65	12	1,5	-	35°	001	
9,65	12	1,5	-	35°	002	
12	12	1,5	-	35°	003	
15	12	1,5	-	35°	004	
20	12	1,5	-	35°	005	
30	12	1,5	14	35°	006	
40	12	1,5	26	35°	007	
50	12	1,5	26	35°	008	
60	12	1,5	26	35°	009	
80	13	2,2	60	35°	010	
100	13	2,2	60	35°	011	
120	13	2,2	60	35°	012	

REVERSIBLE HM INTEGRAL KNIVES WITH RAKE OF 45°

9504...

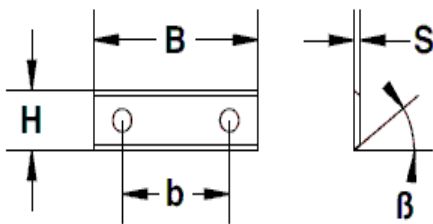

B	H	S	b	β		€
7,65	12	1,5	-	45°	001	
12	12	1,5	-	45°	002	
15	12	1,5	-	45°	003	
20	12	1,5	-	45°	004	
30	12	1,5	14	45°	005	
40	12	1,5	26	45°	006	
50	12	1,5	26	45°	007	
60	12	1,5	26	45°	008	

REVERSIBLE HM INTEGRAL KNIVES KCR08

9505...

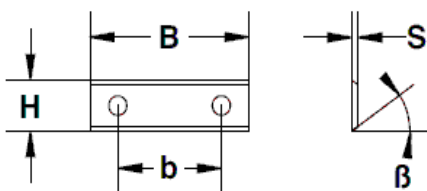

B	H	S	b	β		€
20	12	1,5	-	35°	001	
30	12	1,5	14	35°	002	
50	12	1,5	26	35°	003	

REVERSIBLE HM INTEGRAL KNIVES WITH HEIGHT OF 9mm

9506...

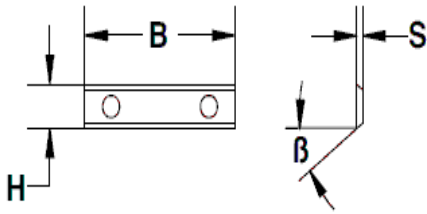

B	H	S	β				€
7,5	9	1,5	35°			001	
9,6	9	1,5	35°			002	
12	9	1,5	35°			003	
14,6	9	1,5	35°			004	
20	9	1,5	35°			005	
30	9	1,5	35°			006	
40	9	1,5	35°			007	
50	9	1,5	35°			008	
60	9	1,5	35°			009	

REVERSIBLE HM INTEGRAL MINI - KNIVES

9507...

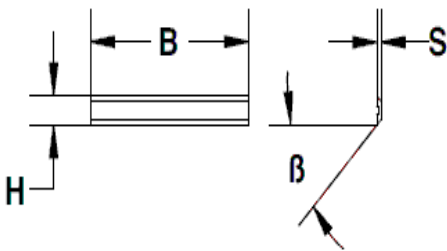

B	H	S	β				€
12	5,5	1,1	35°			001	
20	5,5	1,1	35°			002	
30	5,5	1,1	35°			003	
40	5,5	1,1	35°			004	
50	5,5	1,1	35°			005	

REVERSIBLE HM INTEGRAL MINI - KNIVES

9507a...

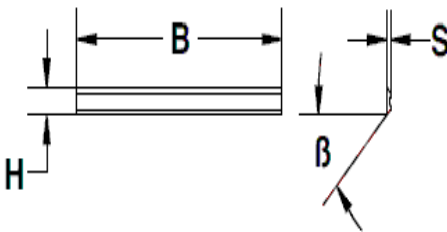

B	H	S	β				€
82	5,5	1,1	35°			051	

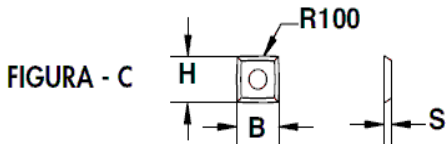
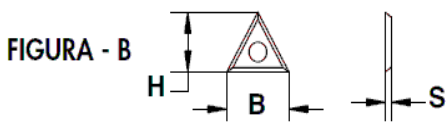
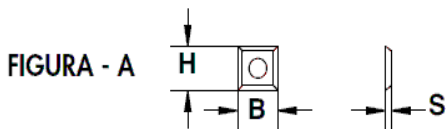

REVERSIBLE HM INTEGRAL TRIMMERS

9508...

B	H	S	FIGURA				€
14	14	1,2	A			001	
14	14	2	A			002	
22	19	2	B			003	
15	15	2,5	C			011	

REVERSIBLE HM INTEGRAL KNIVES FOR GROOVE CUTTER HEADS

9509...

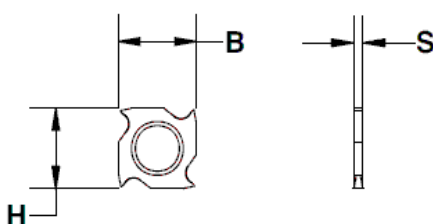

B	H	S					€
18	18	1,95				001	
18	18	2,95				002	

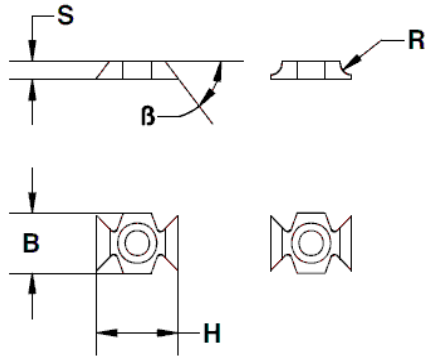

ALL-HM INTEGRAL BEVELLER INSERTS

9510...

B	H	S	β	RAGGIO		€
16	22	5	45°	-	001	
16	22	5	-	R1,5	002	
16	22	5	-	R2	003	
16	22	5	-	R3	004	
16	22	5	-	R4	005	
16	22	5	-	R5	006	

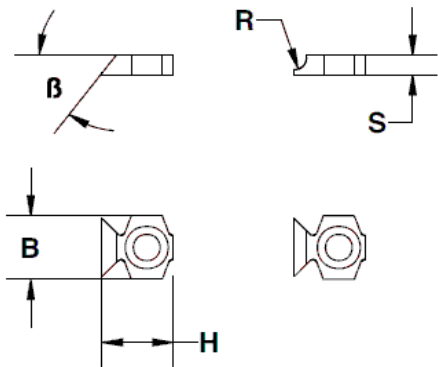

ALL-HM INTEGRAL BEVELLER INSERTS

9511...

B	H	S	β	RAGGIO		€
16	16,5	5	45°	-	001	
16	16,5	5	-	R1,5	002	
16	16,5	5	-	R2	003	
16	16,5	5	-	R3	004	
16	16,5	5	-	R4	005	
16	16,5	5	-	R5	006	

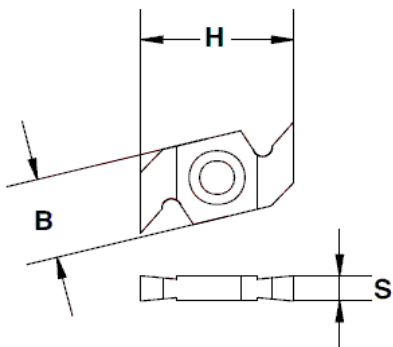

INSERTS IN HM INTEGRAL FOR GASKET GROOVE

9512...

B	H	S				€
16	29	4			001	
16	29	5			002	
16	29	6			003	

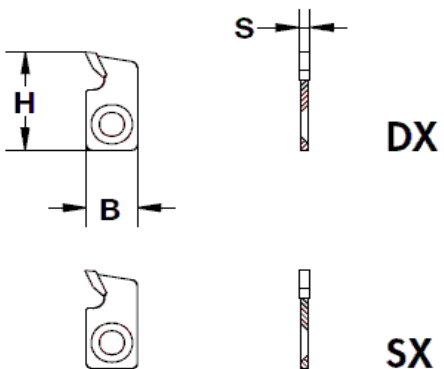

ALL - HM INTEGRAL INSERTS

9513...

B	H	S			DX	SX	€
16	32,5	3			051	052	
16	32,5	4			053	054	
16	32,5	5			055	056	
16	32,5	6			057	058	
16	32,5	7			059	060	
16	32,5	8			061	062	

9514...

ΤΙΠΟ - Α

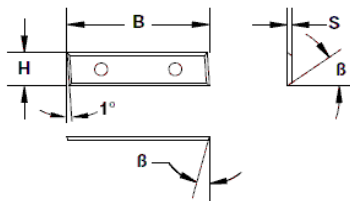

ΤΙΠΟ - Β

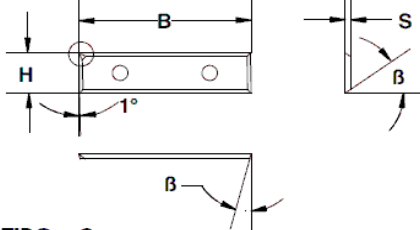

ΤΙΠΟ - C

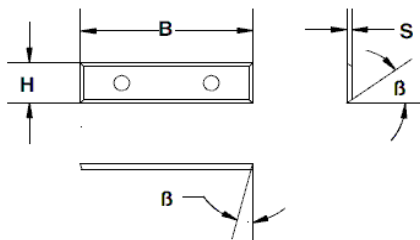

Knives with inclined at 1° lateral cutting

B	H	S	ΤΙΠΟ	β		€
30	12	1,5	A	35°	001	
50	12	1,5		35°	002	
30	9	1,5		35°	011	
50	9	1,5		35°	012	

Knives with inclined at 1° lateral cutting and double back grinding

B	H	S	ΤΙΠΟ	β		€
30	12	1,5	B	35°	021	
50	12	1,5		35°	022	
30	9	1,5		35°	023	

Rectangular knives with 4 sides cutting

B	H	S	ΤΙΠΟ	β		€
30	12	1,5	C	35°	051	
50	12	1,5		35°	052	
30	9	1,5		35°	053	

REVERSIBLE HM INTEGRAL KNIVES

9515...

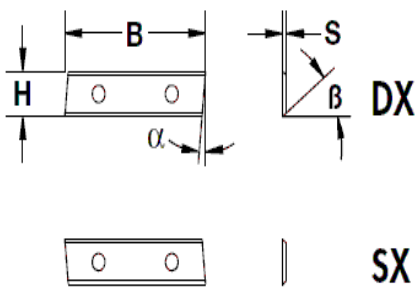

B	H	S	a	β	DX	SX	€
7,5	12	1,5	6°	35°	001	002	
9,65	12	1,5	6°	35°	003	004	
12	12	1,5	6°	35°	005	006	
15	12	1,5	6°	35°	007	008	
20	12	1,5	6°	35°	009	010	
30	12	1,5	6°	35°	011	012	
40	12	1,5	6°	35°	013	014	
50	12	1,5	6°	35°	015	016	
7,5	12	1,5	12°	35°	051	052	
9,65	12	1,5	12°	35°	053	054	
12	12	1,5	12°	35°	055	056	
15	12	1,5	12°	35°	057	058	
20	12	1,5	12°	35°	059	060	
30	12	1,5	12°	35°	061	062	
40	12	1,5	12°	35°	063	064	
50	12	1,5	12°	35°	065	066	

REVERSIBLE HM INTEGRAL KNIVES WITH RAKE OF 45°

9516...

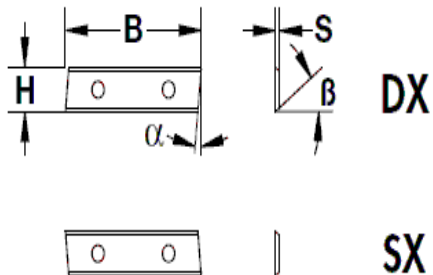

B	H	S	a	β	DX	SX	€
7,5	12	1,5	6°	45°	001	002	
15	12	1,5	6°	45°	005	006	
20	12	1,5	6°	45°	007	008	
30	12	1,5	6°	45°	009	010	
40	12	1,5	6°	45°	011	012	
50	12	1,5	6°	45°	013	014	
7,5	12	1,5	12°	45°	051	052	
15	12	1,5	12°	45°	055	056	
20	12	1,5	12°	45°	057	058	
30	12	1,5	12°	45°	059	060	
40	12	1,5	12°	45°	061	062	
50	12	1,5	12°	45°	063	064	

REVERSIBLE HM INTEGRAL KNIVES BEVELLED IN 4 SIDES

9517...

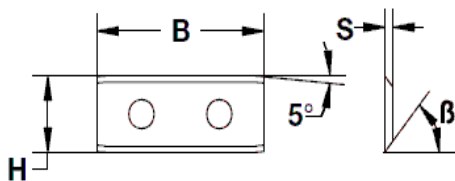

B	H	S	β				€
30	12	1,5	35°			001	
40	12	1,5	35°			002	
30	12	1,5	45°			051	

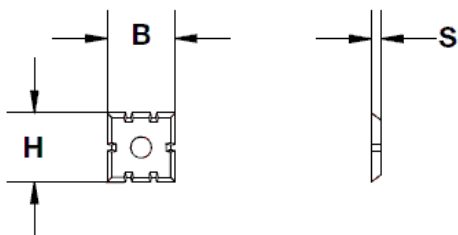

KNIFE HM INTEGRAL WITH CHIPBREAKER

9518...

B	H	S					€
7,5	12	1,5				001	

PROFIED SPARE KNIVES HM INTEGRAL

9519...

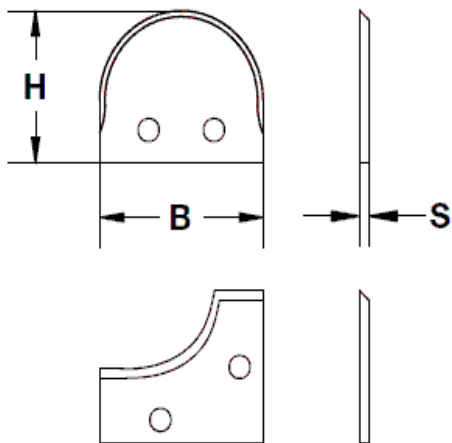

B	H	S					€
20	20	2				001	
20	25	2				002	
20	30	2				003	
20	35	2				004	
25	20	2				005	
25	25	2				006	
25	30	2				007	
25	35	2				008	
30	20	2				009	
30	25	2				010	
30	30	2*				011	
30	35	2				012	
30	40	2				013	
35	25	2				014	
35	30	2*				015	
35	35	2*				016	
35	40	2				017	
40	20	2				018	
40	25	2				019	
40	30	2*				020	
40	35	2*				021	
40	40	2*				022	
50	25	2				023	
50	30	2				024	
50	35	2				025	
50	40	2				026	
50	45	2				027	
60	30	2				028	
60	35	2				029	
60	40	2				030	
80	30	2				031	
80	35	2				032	
80	40	2				033	
100	30	2				034	
100	35	2				035	
100	40	2				036	

* also available with staggd holes

** ΚΩΔΙΚΟΙ A - B - C - D - E

SPARE KNIVES TO PROFILE HM INTEGRAL

9519a...

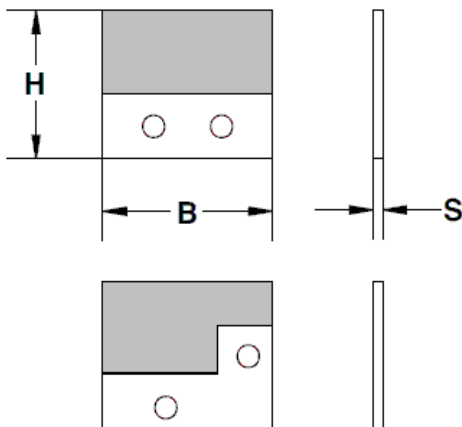

B	H	S					€
20	20	2				101	
20	25	2				102	
20	30	2				103	
20	35	2				104	
25	20	2				105	
25	25	2				106	
25	30	2				107	
25	35	2				108	
30	20	2				109	
30	25	2				110	
30	30	2*				111	
30	35	2				112	
30	40	2				113	
35	25	2				114	
35	30	2*				115	
35	35	2*				116	
35	40	2				117	
40	20	2				118	
40	25	2				119	
40	30	2*				120	
40	35	2*				121	
40	40	2*				122	
50	25	2				123	
50	30	2				124	
50	35	2				125	
50	40	2				126	
50	45	2				127	
60	30	2				128	
60	35	2				129	
60	40	2				130	
80	30	2				131	
80	35	2				132	
80	40	2				133	

* also available with staggered holes

SPARE BACK-KNIVES TO PROFILE HM INTEGRAL

9519b...

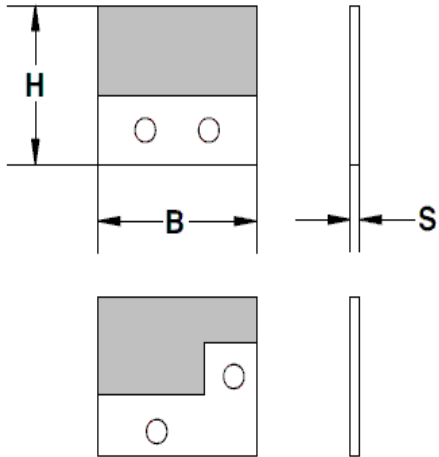

B	H	S					€
30	28	5				201	
30	33	5				202	
30	38	5				203	
35	28	5				213	
35	33	5				214	
35	38	5				215	
40	28	5				204	
40	33	5				205	
40	38	5				206	
60	28	5				207	
60	33	5				208	
60	38	5				209	
80	28	5				210	
80	33	5				211	
80	38	5				212	

PROFILED SPARE BACK-KNIVES HM INTEGRAL

9519c...

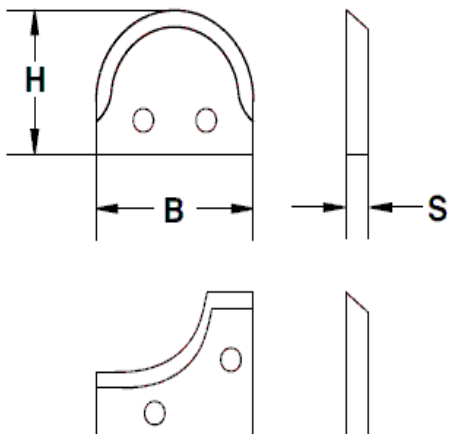

B	H	S					€
30	28	5				301	
30	33	5				302	
30	38	5				303	
35	28	5				313	
35	33	5				314	
35	38	5				315	
40	28	5				304	
40	33	5				305	
40	38	5				306	
60	28	5				307	
60	33	5				308	
60	38	5				309	
80	28	5				310	
80	33	5				311	
80	38	5				312	

SHAPED SPARE CUTTERS FOR ART. 2007

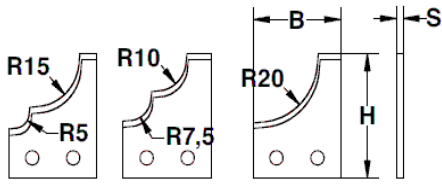

9520...

B	H	S	R				€
30	40	2	7,5-10			001	
30	40	2	5-15			002	
30	40	2	20			003	

SHAPED SPARE CUTTERS FOR ART. 2008

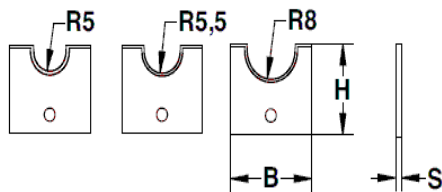

9521...

B	H	S	R				€
25	30	2	5			001	
25	30	2	5,5			002	
25	30	2	8			003	

SHAPED SPARE CUTTERS FOR ART. 2009

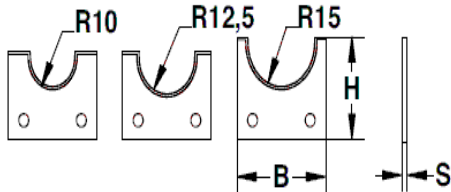

9522...

B	H	S	R				€
40	35	2	10			001	
40	35	2	12,5			002	
40	35	2	15			003	

SHAPED SPARE CUTTERS FOR ART. 2010

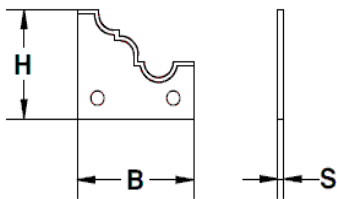

9523...

B	H	S					€
40	35	2				001	

SHAPED SPARE CUTTERS FOR ART. 2011

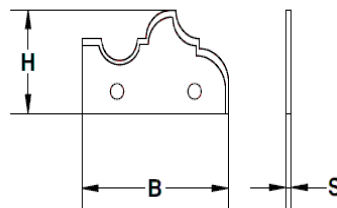

9524...

B	H	S					€
50	30	2				001	

SHAPED SPARE CUTTERS FOR ART. 2012

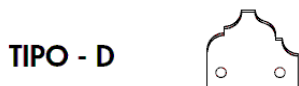
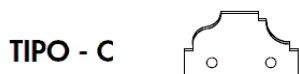
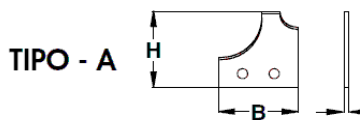

9525...

B	H	S	TIPO				€
35	35	2	A			001	
50	30	2	B			002	
50	35	2	C			003	
40	35	2	D			004	

ΤΙΠΟ - 1 ΤΙΠΟ - 2 ΤΙΠΟ - 3

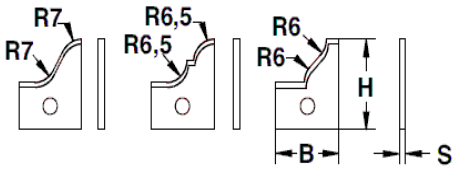

SHAPED SPARE CUTTERS FOR ART. 2015

9526...

B	H	S	TIPO			€
20	25	2	1		001	
20	25	2	2		002	
20	25	2	3		003	

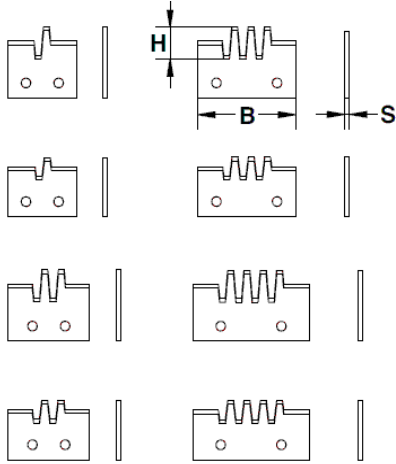

SHAPED SPARE CUTTERS FOR ART. 2028

9527...

B	H	S	H			€
30	25	2	8		001	
30	30	2	12		002	
35	25	2	8		003	
35	30	2	12		004	
42	25	2	8		005	
42	28	2	12		006	
50	25	2	8		007	
50	30	2	12		008	

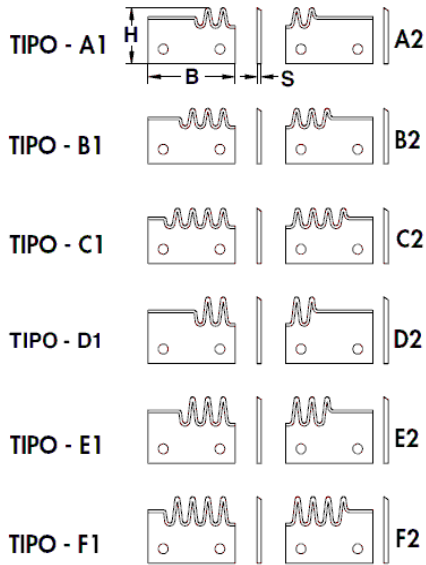

SHAPED SPARE CUTTERS FOR ART. 2029

9528...

B	H	S	TIPO			€
40	25	2	A1		011	
40	25	2	A2		012	
40	25	2	B1		013	
40	25	2	B2		014	
40	25	2	C1		015	
40	25	2	C2		016	
40	30	2	D1		021	
40	30	2	D2		022	
40	30	2	E1		023	
40	30	2	E2		024	
40	30	2	F1		025	
40	30	2	F2		026	

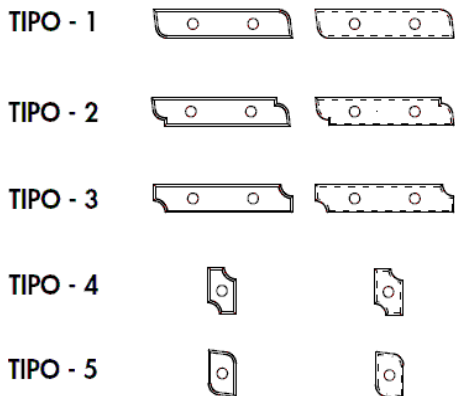

SHAPED SPARE CUTTERS FOR ART. 2040

9532...

B	H	S	TIPO	DX	SX	€
60	12	1,5	1	001	002	
60	12	1,5	2	003	004	
60	12	1,5	3	005	006	
20	12	1,5	4	021	022	
20	12	1,5	5	023	024	

ΠΑΠΑΔΗΜΗΤΡΟΠΟΥΛΟΣ ΠΑΝΑΓΙΩΤΗΣ

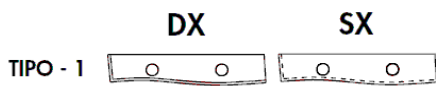

SHAPED SPARE CUTTERS FOR ART. 2041

9533...

B	H	S	TIPO		DX	SX	€
60	12	1,5	1		001	002	
20	12	1,5	4		021	022	
20	12	1,5	5		023	024	

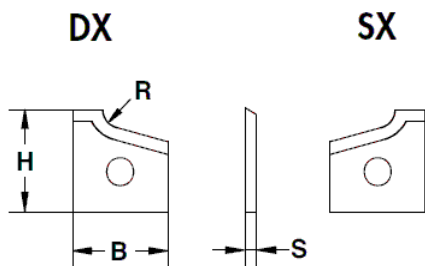

SHAPED SPARE CUTTERS FOR ART. 204ε

9534...

B	H	S	R		DX	SX	€
16	17	2	2		001	002	
16	17	2	3		005	006	
16	17	2	3		003	004	
16	17	2	2-2°		007	008	
16	17	2	2-1,5°		009	010	

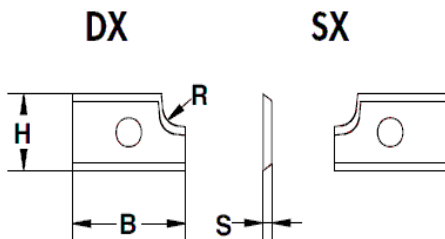

SHAPED SPARE CUTTERS FOR ART. 204ε

9535...

B	H	S	Raggio		DX	SX	€
20	12	1,5	2		001	002	
20	12	1,5	3		003	004	

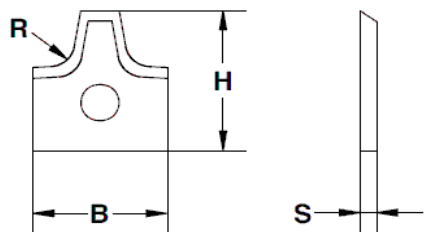

SHAPED SPARE CUTTERS FOR ART. 2047 - 3041

9536...

B	H	S	TIPO				€
16	42	2	A			001	
16	17,5	2	B			002	
16	13,4	2	C			003	
16	14,4	2	D			004	
16	13,15	2	E			101	
16	14,4	2	F			005	

SHAPED SPARE CUTTERS FOR ART. 3040

9538...

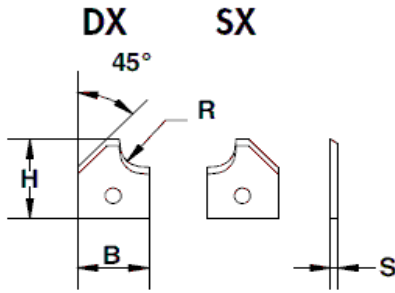

B	H	S	Raggio	DX	SX	€
20	25	2	2-45°	001-01	002-01	
20	25	2	3-45°	001-02	002-02	
20	25	2	4-45°	001-03	002-03	
20	25	2	5-45°	001-04	002-04	
20	25	2	6-45°	001-05	002-05	

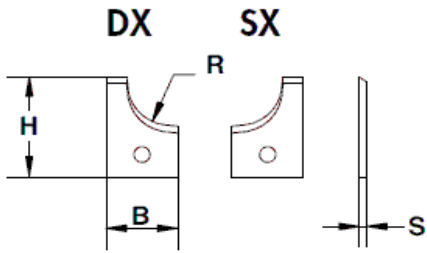

20	30	2	6	003-01	004-01	
20	30	2	7	003-02	004-02	
20	30	2	8	003-03	004-03	
20	30	2	9	003-04	004-04	
20	30	2	10	003-05	004-05	
20	30	2	11	003-06	004-06	
20	30	2	12	003-07	004-07	

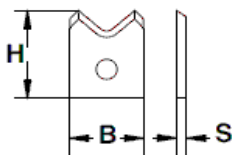

16	20	2	2		011	
16	20	2	3		012	
16	20	2	4		013	
16	20	2	5		014	
16	20	2	6		015	

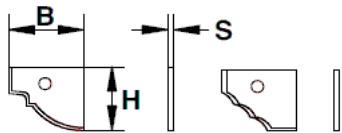

SHAPED SPARE CUTTERS FOR ART. 3050

9539...

TIPO - A

TIPO - B

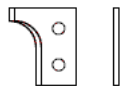

TIPO - C

TIPO - D

B	H	S	TIPO			€
30	25	2	A		001	
30	25	2	B		002	
15	25	2	C		003	
30	25	2	D		004	

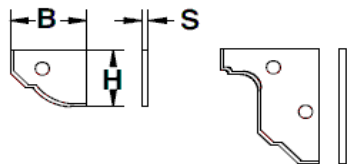

TIPO - A

TIPO - B



TIPO - C

TIPO - D

SHAPED SPARE CUTTERS FOR ART. 3051

9540...

B	H	S	TIPO			€
25	20	2	A		001	
40	35	2	B		002	
22,4	12	1,5*	C		003	
23,8	12	1,5*	D		004	

* realised using knife 30X12X1,5

SHAPED SPARE CUTTERS FOR ART. 305€

9542...

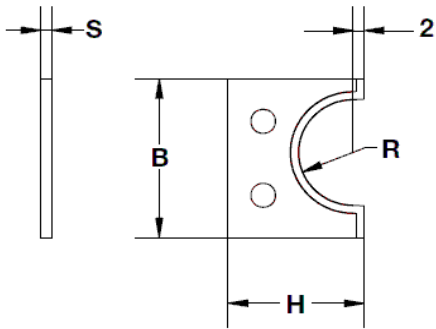

B	H	S	R				€
25	25	2	6			011	
25	25	2	8			012	
25	25	2	9			013	
35	30	2	10			014	
35	30	2	12			015	
35	30	2	12,5			016	
50	35	2	15			017	
50	35	2	17,5			018	
50	35	2	20			019	
60	40	2	22,5			020	
60	40	2	25			021	

SHAPED SPARE CUTTERS FOR ART. 305€

9543...

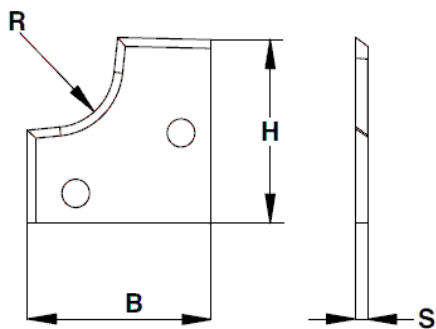

B	H	S	R				€
25	25	2	6			011	
25	25	2	8			012	
25	25	2	9			013	
30	30	2	10			014	
30	30	2	12			015	
30	30	2	12,5			016	
35	35	2	15			017	
35	35	2	17,5			018	
35	35	2	20			019	
40	40	2	22,5			020	
40	40	2	25			021	

SHAPED SPARE CUTTERS FOR ART. 3061

9549...

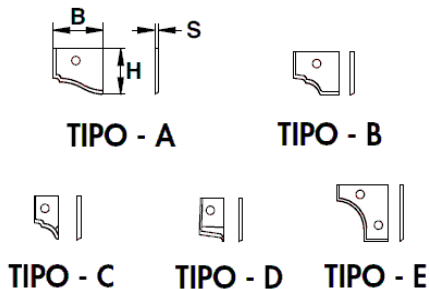

B	H	S	TIPO				€
30	25	2	A			001	
25	25	2	B			002	
15	25	2	C			003	
15	25	2	D			004	
30	30	2	E			005	

FIGURA - A



FIGURA - B



FIGURA - C

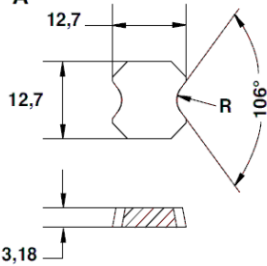

FIGURA - D

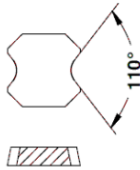

FIGURA - E

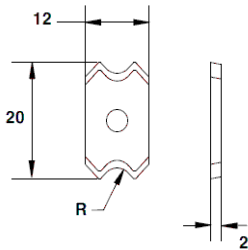

FIGURA - F

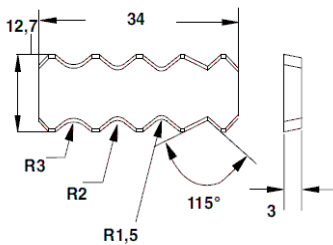

SHARED TIPS FOR SCRAPER ART. 2048 - 2057 - 2058
9550...

FIGURA -A FOR ART 2048 TIPO SCM

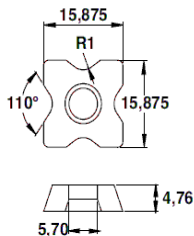
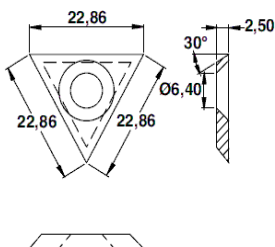
		Raggio				€
12,7	12,7	3,18	1		001	
12,7	12,7	3,18	1,5		002	
12,7	12,7	3,18	2		003	
12,7	12,7	3,18	3		004	

FIGURA-B FOR ART 2048 TIPO BIESSE

		Raggio				€
12,7	12,7	3,18	1		101	
12,7	12,7	3,18	1,5		102	
12,7	12,7	3,18	2		103	
12,7	12,7	3,18	3		104	

FIGURA-C FOR ART. 2057 SAGOMATA

		Raggio				€
20	12	2	1		201	
20	12	2	1,5		202	
20	12	2	2		203	
20	12	2	3		204	

FIGURA-D FOR ART. 2058 SAGOMATA

		Raggio				€
34	12,7	3	1-2-3-115°		301	
34	12,7	3	1,5-2-3-115°		302	
34	12,7	3	2-3-5-115°		303	
34	12,7	3	1,5-2-2,5-115°		304	

FIGURA-E

		Raggio				€
15,87	15,87	4,76	1		401	
15,87	15,87	4,76	1,5		402	
15,87	15,87	4,76	2		403	
15,87	15,87	4,76	3		404	

FIGURA -F HM TRIANGOLARI 22,86 SP=2,5

					501	
--	--	--	--	--	-----	--

SHAPED SPARE CUTTERS FOR ART. 2052

9551...

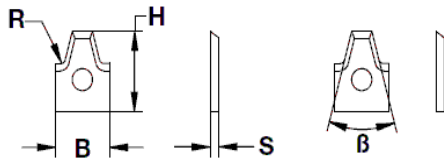

B	H	S	Raggio			€
12	20	2	1,5		003	
12	20	2	2		004	
12	20	2	3		006	
12	20	2	4		008	
15	20	2	5		010	
12	20	2	30°		021	
12	20	2	45°		022	
12	20	2	60°		023	

DX

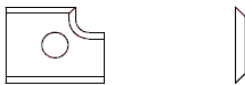

SHAPED SPARE CUTTERS FOR ART. 2053

9552...

SX

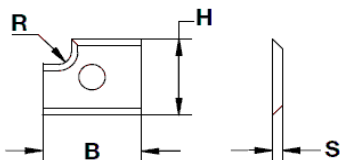

B	H	S	Raggio	DX	SX	€
20	12	1,5	1,5	001	002	
20	12	1,5	2	003	004	
20	12	1,5	3	005	006	

SHAPED SPARE CUTTERS FOR ART. 2051

9553...

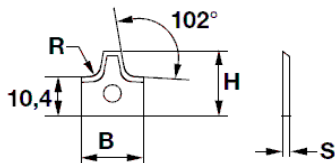

DX

SX

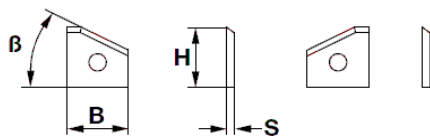

B	H	S	Raggio	DX	SX	€
15	12	1,5	1	001	002	
15	12	1,5	1,5	003	004	
15	12	1,5	2	005	006	
15	12	1,5	2,5	007	008	
15	12	1,5	3	009	010	

SHAPED SPARE CUTTERS FOR ART. 2054

9554...

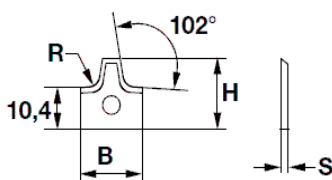

DX

SX

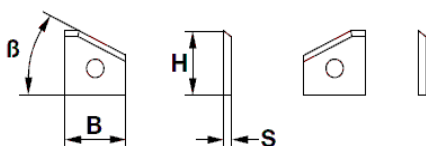

B	H	S	Raggio			€
16	17,5	2	1,5		001	
16	17,5	2	2		002	
16	17,5	2	3		003	
16	17,5	2	4		004	
16	17,5	2	5		005	

B	H	S	β		DX	SX	€
16	15,7	2	25°		011	012	

ΠΑΠΑΔΗΜΗΤΡΟΠΟΥΛΟΣ ΠΑΝΑΓΙΩΤΗΣ

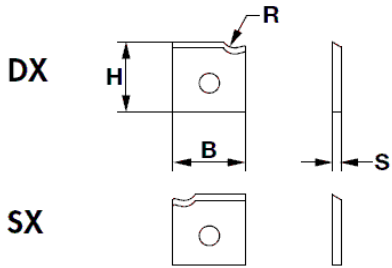

SHAPED SPARE CUTTERS FOR ART. 205€

9555...

B	H	S	Raggio	DX	SX	€
16	15,9	2	1,5	001	002	
16	15,9	2	2	003	004	
16	15,9	2	3	005	006	

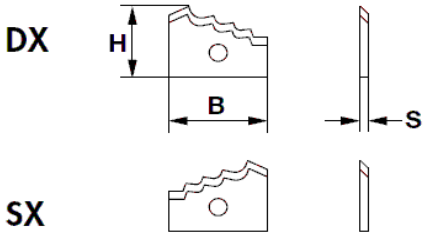

SHAPED SPARE CUTTERS FOR ART. 205€

9556...

B	H	S	Raggio	DX	SX	€
25	18,7	2	1,5-2-3	001	002	

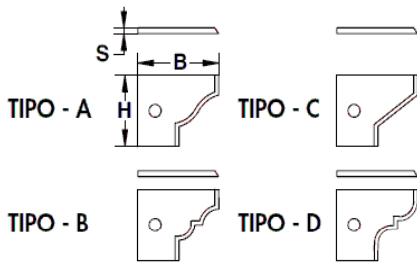

SHAPED SPARE CUTTERS FOR ART. 206€

9557...

B	H	S	TIPO	€
25	30	2	A	001
25	30	2	B	002
25	30	2	C	003
25	30	2	D	004

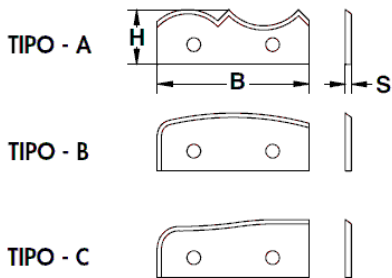

SHAPED SPARE CUTTERS FOR ART. 206€

9558...

B	H	S	Raggio	€
50	18	2	A	001
50	19	2	B	002
50	19	2	C	003

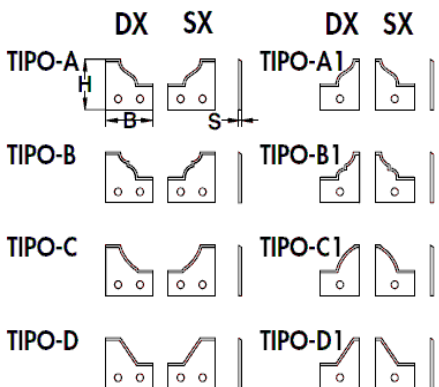

SHAPED SPARE CUTTERS FOR ART. 2066 - 2067

9559...

B	H	S	TIPO	DX	SX	€
30	30	2	A	001	002	
30	30	2	B	003	004	
30	30	2	C	005	006	
30	30	2	D	007	008	
25	30	2	A1	009	010	
25	30	2	B1	011	012	
25	30	2	C1	013	014	
25	30	2	D1	015	016	

ΠΑΠΑΔΗΜΗΤΡΟΠΟΥΛΟΣ ΠΑΝΑΓΙΩΤΗΣ

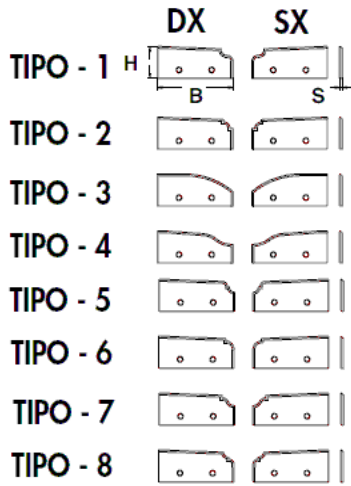

SHAPED SPARE CUTTERS FOR ART. 2069

9560...

B	H	S	TIPO	DX	SX	€
60	25	2	1	001	002	
60	25	2	2	003	004	
60	25	2	3	005	006	
60	25	2	4	007	008	
60	25	2	5	009	010	
60	25	2	6	011	012	
60	25	2	7	013	014	
60	25	2	8	015	016	

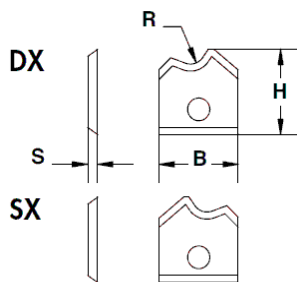

SHAPED SPARE CUTTERS FOR ART. 2071

9562...

B	H	S	Raggio	DX	SX	€
16	17	2	1	001	002	
16	17	2	2	003	004	
16	17	2	3	005	006	

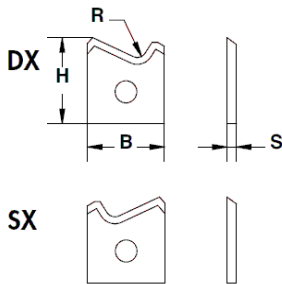

SHAPED SPARE CUTTERS FOR ART. 2072

9563...

B	H	S	Raggio	DX	SX	€
16	17,5	2	2	001	002	
16	17,5	2	3	003	004	

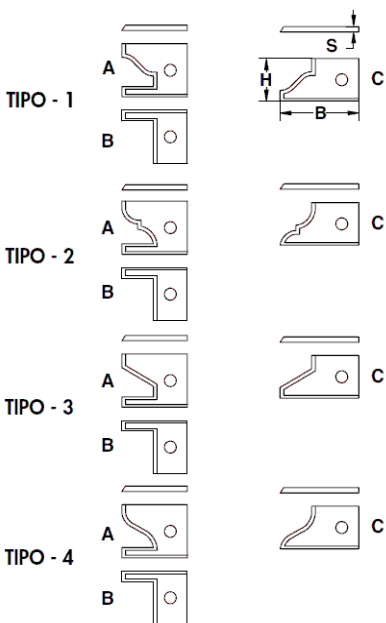

SHAPED SPARE CUTTERS FOR ART. 3049

FOR ART. 3049001

9564...

B	H	S	TIPO-C	€
16	30	2	1	001
16	30	2	2	002
16	30	2	3	003
16	30	2	4	004

FOR ART. 3049003

B	H	S	TIPO-A	€
20	25	2	1	011
20	25	2	2	012
20	25	2	3	013
20	25	2	4	014

B	H	S	TIPO-B	€
20	25	2	1	021

ΠΑΠΑΔΗΜΗΤΡΟΠΟΥΛΟΣ ΠΑΝΑΓΙΩΤΗΣ

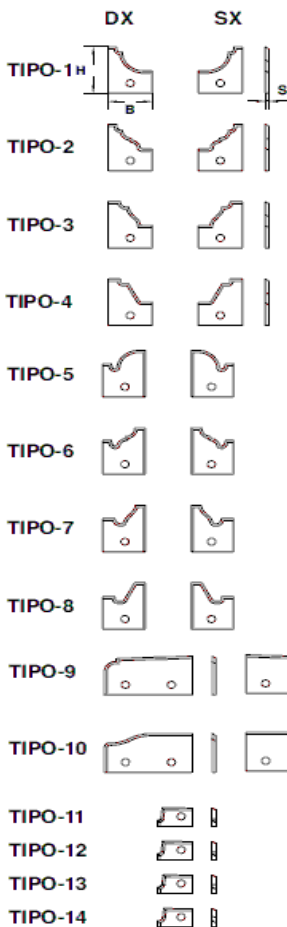
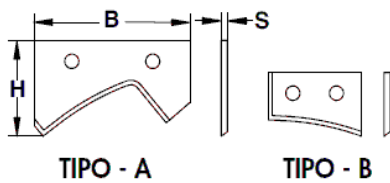
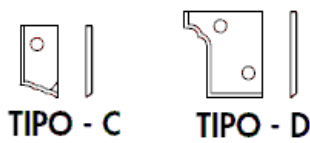
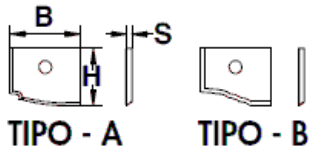
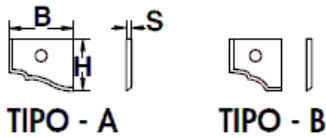

SHAPED SPARE CUTTERS FOR ART. 3069

9566...

B	H	S	TIPO				€
25	20	2	A			001	
20	20	2	B			002	
15	25	2	C			003	
15	25	2	D			004	
30	30	2	E			005	

SHAPED SPARE CUTTERS FOR ART. 3070

9567...

B	H	S	TIPO				€
25	20	2	A			001	
25	20	2	B			002	
15	25	2	C			003	
30	30	2	D			004	

SHAPED SPARE CUTTERS FOR ART. 3071

9568...

B	H	S	TIPO				€
50	30	2	A			001	
30	20	2	B			002	

**SHAPED SPARE CUTTERS FOR ART. 3062
FOR ART. 3062001/002/003/004**

9569...

B	H	S	TIPO		DX	SX	€
25	30	2	1		001	002	
25	30	2	2		003	004	
25	30	2	3		005	006	
25	30	2	4		007	008	
25	30	2	5		009	010	
25	30	2	6		011	012	
25	30	2	7		013	014	
25	30	2	8		015	016	

FOR ART. 3062007

B	H	S	TIPO		DX	SX	€
50	25	2	9		017	018	
50	25	2	10		019	020	

FOR ART. 3062006

B	H	S	TIPO				€
12	19,85	2	11			021	
12	19,85	2	12			022	
12	19,85	2	13			023	
12	19,85	2	14			024	

SHAPED SPARE CUTTERS FOR ART. 3063

9570...

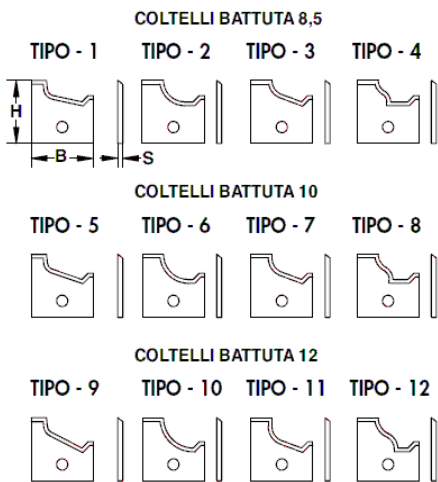

B	H	S	TIPO				€
25	25	2	1			001	
25	25	2	2			002	
25	25	2	3			003	
25	25	2	4			004	
25	25	2	5			011	
25	25	2	6			012	
25	25	2	7			013	
25	25	2	8			014	
25	25	2	9			021	
25	25	2	10			022	
25	25	2	11			023	
25	25	2	12			024	

SHAPED SPARE CUTTERS FOR ART. 2076

9571...

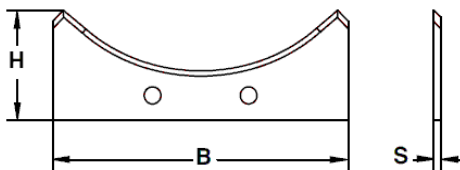

B	H	S	R		DX	SX	€
60	30	2	30		001		
60	30	2	35		002		
60	30	2	40		003		
80	30	2	45		011		
80	30	2	50		012		
80	30	2	55		013		

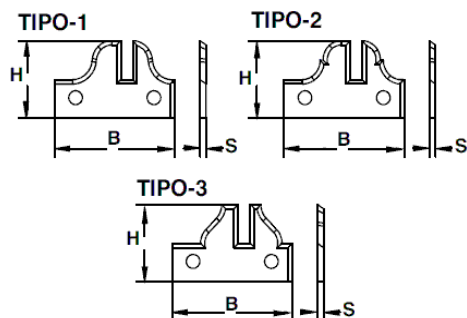

SHAPED SPARE CUTTERS FOR ART. 2077

9572...

B	H	S			DX	SX	€
40	25	2			001		
40	25	2			002		
40	25	2			003		

SHAPED SPARE CUTTERS FOR ART. 203E

9573...

SALTO 8,5

B	H	S	TIPO				€
25	25	2	1			001	
25	25	2	2			002	
25	25	2	3			003	
25	25	2	4			004	

SALTO 10

B	H	S	TIPO				€
25	25	2	5			011	
25	25	2	6			012	
25	25	2	7			013	
25	25	2	8			014	

SALTO 12

B	H	S	TIPO				€
25	25	2	9			021	
25	25	2	10			022	
25	25	2	11			023	
25	25	2	12			024	

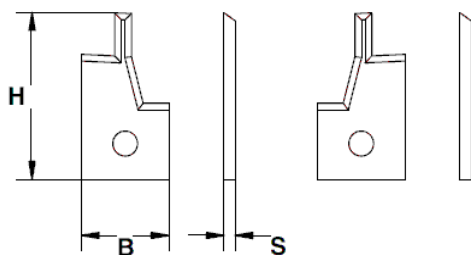
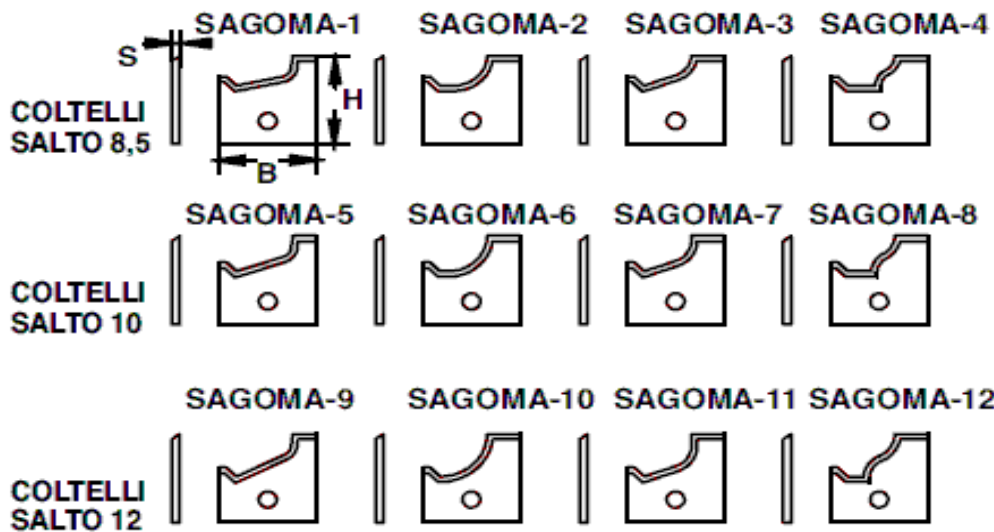

SHAPED SPARE CUTTERS FOR ART. 208C

9574...

B	H	S			DX	SX	€
16	30	2			001	002	

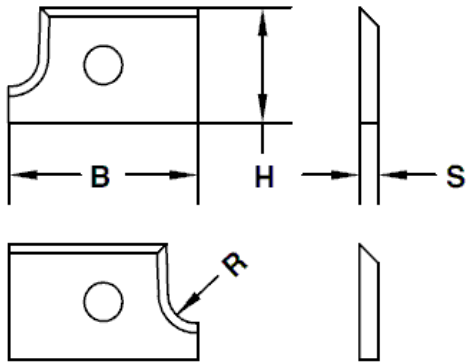

SHAPED SPARE CUTTERS FOR ART. 2081

9575...

B	H	S	Raggio	DX	SX	€
12	20	2	2	001	002	
12	20	2	3	003	004	

TIPO-1

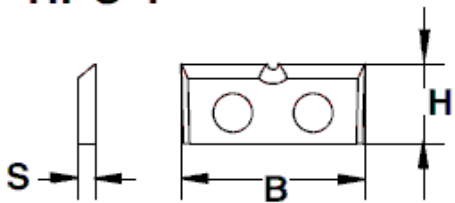

SHAPED SPARE CUTTERS FOR ART. 3073

9576...

B	H	S	TIPO				€
16	7	1,5	1			001	
16	7	1,5	2			002	

TIPO-2

